



Quick Guidelines

for Unicheck Report

Welcome aboard! You are inside a sample document report. It will guide you through the report interface most helpful uses. So, you will be able to manage it like a real pro.



Unicheck report

This is what we call Unicheck's search results. They become available online after checking is completed.

The report shows percentage of matches, highlights unoriginal text along with citations and references and provides links to matching sources.

Once the report is delivered, you can exclude or include sources, citations and references, and do many more things. Let's dig deeper and get a clue.



Minimap

It is on your left. This minimap is designed to quickly review the whole document. Each line in it relates to one or several pages of the text. Hover over any of them to find out percentage of similarity, citations and references detected. By clicking the line, you will be taken to the selected page.

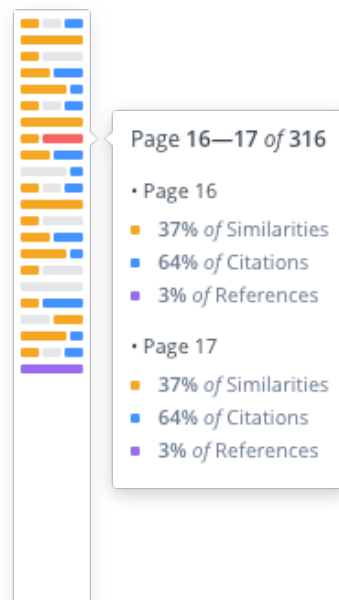



Color mask

Unicheck checks your papers against the Internet and the files you uploaded to Library. You can always disable Library sources if needed.

Unoriginal text, citations and references are highlighted differently. Yellow is for similarity, blue for citations and violet for references. This speeds up reviewing a lot.

Here's how similarity found in the text looks like:

Never trust your brain: it's bad at memory

Very often the ideas that come to us during diffuse mode can be a bit abstract. Out of the box thinking, if you will. This is your best content. The high level, creative, new ideas that are going to take the world by storm. (Brian Lee, 2017)

We know that as time passes our memory for ordinary personal events declines in accuracy. What's more, we also feel that our recollections of those events are fading. (David Ludden, 2016) Memories are constantly in flux, decaying as soon as they have begun to form. (Ed Cooke, 2012) That is, we doubt the accuracy of those memories. (David Ludden, 2016)

Similarity

Take a look at the Similarity tab on your right. It shows total percentage of similarity, citations and references detected. You get informed on number of sources having similar content too. A list of them is below.

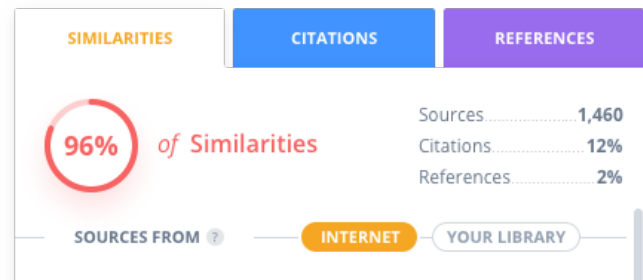

Each source has a similarity score. The sources with the biggest amount of matches are at the top. You can view or exclude them. The latter makes sense if some sources haven't been used in your work.

Citations

Citation detection is on by default. It means that all the quoted sentences will not be treated as plagiarism and that a total similarity score will decrease. If you choose to turn it off, Unicheck will update percentage of matches and it is likely to grow. You can do this inside the Citations tab.

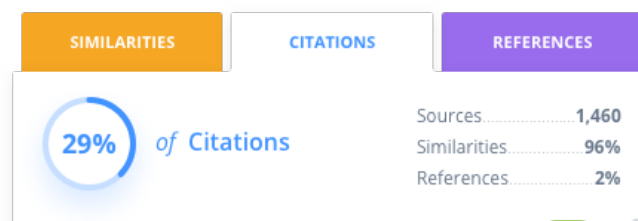

If a citation hasn't been spotted, check whether it is formatted the right way or not. Unicheck recognizes MLA, APA, Chicago, Harvard, and Turabian.

CITATION SAMPLE IN MLA FORMAT

The poetry is described as a "spontaneous overflow of powerful feelings" (Wordsworth 263).

CITATION SAMPLE IN APA FORMAT

As the writer claimed "the darkest days were still ahead" (Weston, 1988, p. 45).

CITATION SAMPLE IN HARVARD FORMAT

Smith (2010) asserted that about 20% of Canadians have a language other than English or French as their mother tongue.



References detection

The tab with stats on references is next to Similarity and Citations. When references detection is on, works cited list at the end of your paper will be highlighted in violet. In such a case, references will not be considered plagiarism. This is how references will be marked inside the report.

References:

1. Allen, T. (1974). Vanishing wildlife of North America. Washington, D.C.: National Geographic Society.
2. Boorstin, D. (1992). The creators: A history of the heroes of the imagination. New York: Random House.
3. Searles, B., & Last, M. (1979). A reader's guide to science fiction. New York: Facts on File, Inc.



PDF report

After checking is completed, you can download Unicheck's report in PDF. You just need to hit the Download PDF report button.

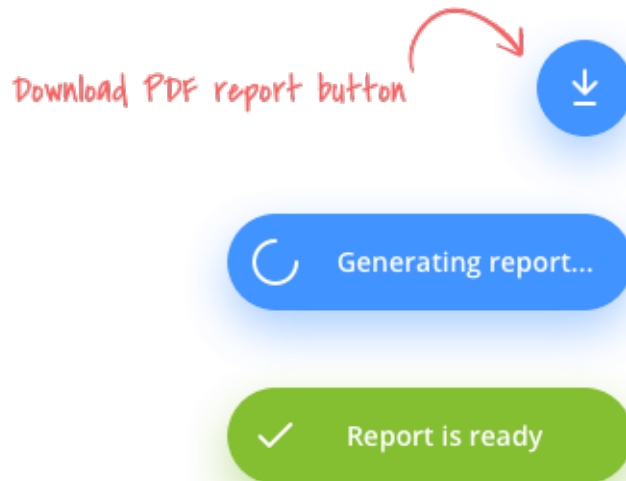

The offline report mirrors all the information given in its online version. Thus, it highlights similarity, citations and references and lists all the matching sources.



Congrats!

Now, you know everything about Unicheck's updated interface.

Hopefully, these guidelines were of big help for you.